

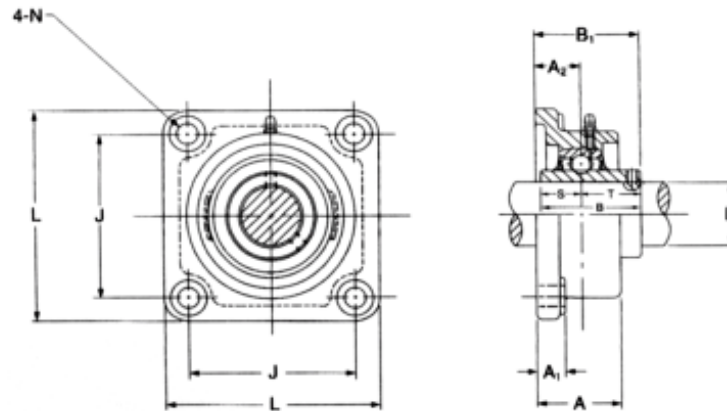

## Mounted Units and Insert Bearing

### P.1

### RAM 4-BOLT FLANGE BEARINGS SET SCREW



Ram No.	Shaft Dia.		Dimensions										Bolt Size		Wt. (lbs)
	D		L	J	N	A	A <sub>1</sub>	A <sub>2</sub>	B <sub>1</sub>	B	S	T	(in)	(mm)	
	(in)	(mm)													
UCF-201-08	1/2	12.70	3 3/8	2 33/64	15/32	1	7/16	19/32	1 19/64	1.0787	0.4528	0.6259	3/8	10	1.3
UCF-202-10	5/8	15.00	3 3/8	2 33/64	15/32	1	7/16	19/32	1 19/64	1.0787	0.4528	0.6259	3/8	10	1.2
UCF-204-12	3/4	19.05	3 3/8	2 33/64	15/32	1	7/16	19/32	1 5/16	1.2205	0.5000	0.7205	3/8	10	1.3
UCF-205-14	7/8	22.22	3 11/16	2 3/4	15/32	1 1/16	1/2	5/8	1 13/32	1.3386	0.5630	0.7756	3/8	10	1.8
UCF-205-16	1	25.40	3 11/16	2 3/4	15/32	1 1/16	1/2	5/8	1 13/32	1.3386	0.5630	0.7756	3/8	10	1.8
UCF-206-18	1 1/8	28.57	4 3/16	3 9/32	15/32	1 7/32	1/2	45/64	1 19/32	1.5000	0.6260	0.8740	3/8	10	2.4
UCF-206-19	1 3/16	30.16	4 3/16	3 9/32	15/32	1 7/32	1/2	45/64	1 19/32	1.5000	0.6260	0.8740	3/8	10	2.4
UCF-206-20	1 1/4	31.75	4 3/16	3 9/32	15/32	1 7/32	1/2	45/64	1 19/32	1.5000	0.6260	0.8740	3/8	10	2.4
UCF-207-20	1 1/4	31.75	4 9/16	3 5/8	35/64	1 11/32	19/32	3/4	1 3/4	1.6890	0.6890	1.0000	7/16	12	3.1
UCF-207-22	1 3/8	34.92	4 9/16	3 5/8	35/64	1 11/32	19/32	3/4	1 3/4	1.6890	0.6890	1.0000	7/16	12	3.1
UCF-207-23	1 7/16	36.51	4 9/16	3 5/8	35/64	1 11/32	19/32	3/4	1 3/4	1.6890	0.6890	1.0000	7/16	12	3.1
UCF-208-24	1 1/2	38.10	5 1/16	4 1/64	35/64	1 13/32	19/32	53/64	2 1/64	1.9370	0.7480	1.1890	7/16	12	4.0
UCF-209-27	1 11/16	42.86	5 5/16	4 9/64	5/8	1 1/2	5/8	7/8	2 1/16	1.9370	0.7480	1.1890	1/2	14	4.9
UCF-209-28	1 3/4	44.45	5 5/16	4 9/64	5/8	1 1/2	5/8	7/8	2 1/16	1.9370	0.7480	1.1890	1/2	14	4.9
UCF-210-31	1 15/16	49.21	5 5/8	4 3/8	11/16	1 9/16	5/8	7/8	2 5/32	2.0315	0.7480	1.2835	5/8	16	5.3
UCF-210-32	2	50.80	5 5/8	4 3/8	11/16	1 9/16	5/8	7/8	2 5/32	2.0315	0.7480	1.2835	5/8	16	5.3
UCF-211-32	2	50.80	6 3/8	5 1/8	11/16	1 11/16	23/32	63/64	2 5/16	2.1890	0.8740	1.3150	5/8	16	7.7
UCF-211-35	2 3/16	55.56	6 3/8	5 1/8	11/16	1 11/16	23/32	63/64	2 5/16	2.1890	0.8740	1.3150	5/8	16	7.7
UCF-212-39	2 7/16	61.91	6 7/8	5 5/8	11/16	1 7/8	23/32	1 9/64	2 45/64	2.5630	1.0000	1.5630	5/8	16	9.3
UCF-215-47	2 15/16	74.61	7 7/8	6 1/4	11/16	2 7/32	7/8	1 11/32	3 3/32	3.0630	1.3110	1.7520	5/8	16	13.9
UCF-215-48	3	75.00	7 7/8	6 1/4	11/16	2 7/32	7/8	1 11/32	3 3/32	3.0630	1.3110	1.7520	5/8	16	13.9











